



Scan QR to view  
Assembly video

# **CEI Machine Vision Accessories for Matrox® Iris GTR**

As a leading innovator in the Machine Vision Industry, CEI is proud to introduce our new line of Machine Vision Camera Enclosures, Cables, and Accessories for demanding vision applications.

## **CEI Accessories for Matrox® Iris GTR**

- **IP67 Lens Covers**  
P/N: EN-DC55-XX\*



- **25mm Lens Cover Extension Ring**  
P/N: EN-DC55-25-XR



- **Swivel link mount adapter, fits SLM-1 and ASFB-1**  
P/N: EN-SL-A

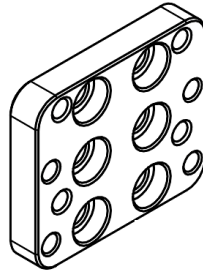

- **Flip Light Bracket for Smart Vision Lights® and other Lights**  
P/N: E-GTR-LB

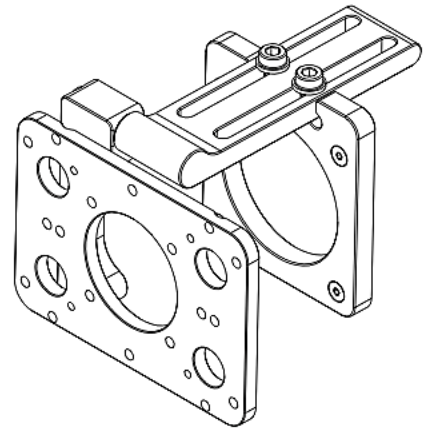

- **Disposable Protective Window for EN-DC55 Lens Covers**  
P/N: GMLC-75-PW

- **CEI Machine Vision Cables for Matrox® Iris GTR**  
(see page 2)



**EN-DC55-75 IP67**  
Lens cover installed on  
Matrox® Iris GTR

## CEI Machine Vision Cables for Matrox® Iris GTR

- M12 X-Code Gigabit Ethernet cables straight  
P/N: MI-1-X-L0-XXM

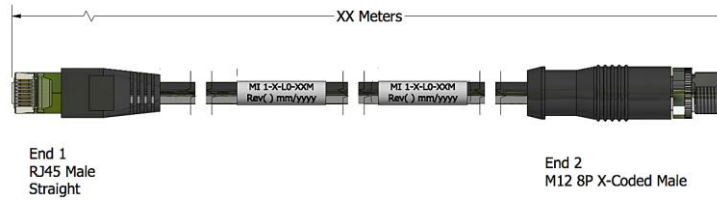

- M12 X-Code Gigabit Ethernet cables right angle  
P/N: MI-1-X-L2-XXM

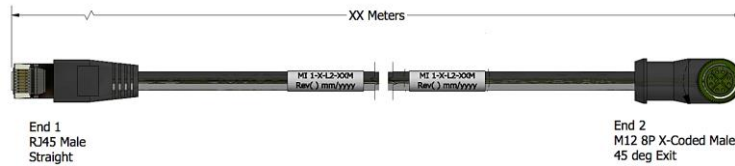

- M12 X-Code to Industrial Ethernet cables  
P/N: MI-K0-X-L0-XXM

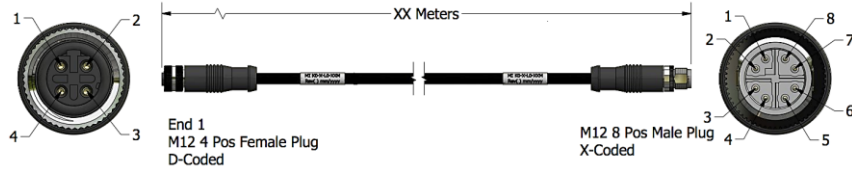

- Specific breakout cables:

Contact CEI for Application and Configuration Details.

**VGA/USB I/O cable**  
P/N: GTR-VGA-USB

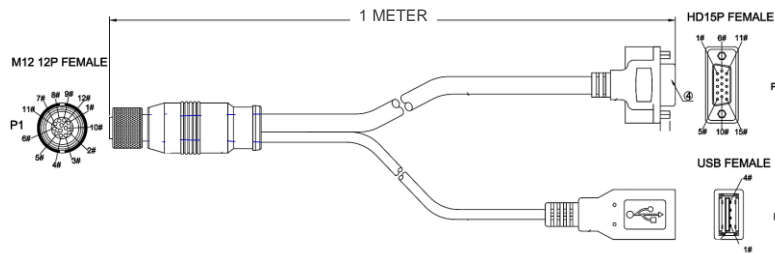

**Light Breakout Cable**

P/N: GTR-LTYCBL

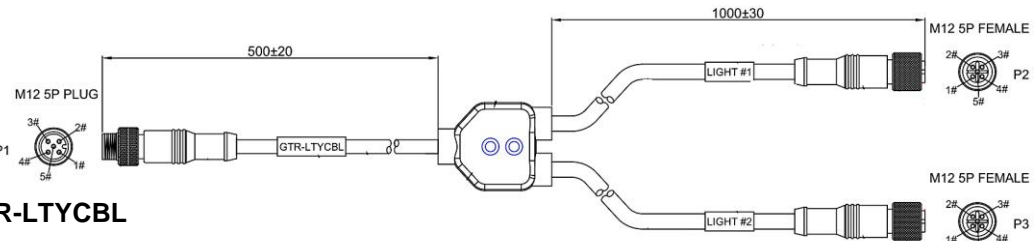

**Power Breakout Cable for Camera & Light:**

P/N: GTR-YCBL

